

NOTES

- | | |
|---|---|
| 1 | Steps partly covered by debris; dimensions approximate. |
| 2 | Protrusion at ceiling, possibly remains of door jamb; dimensions approximate. |

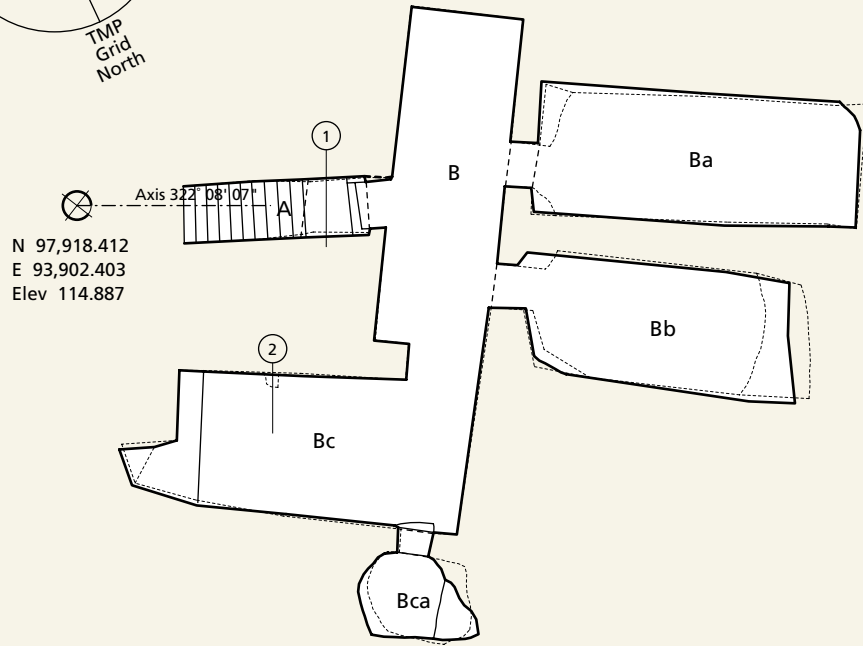

N 97,918.412
E 93,902.403
Elev 114.887

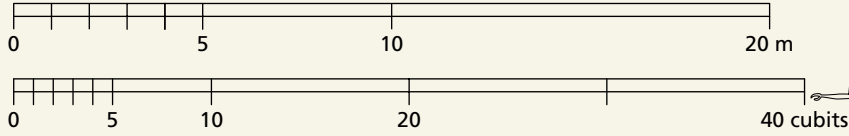
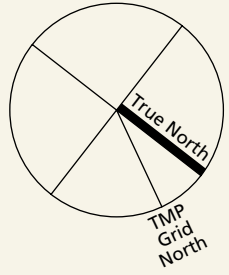
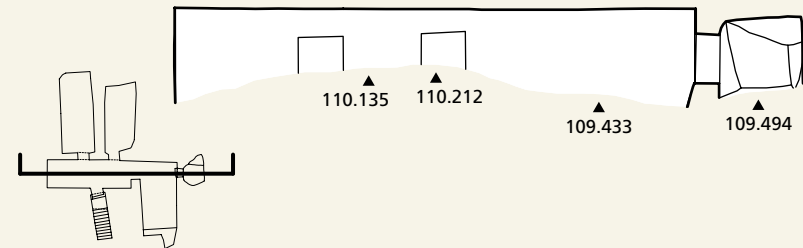
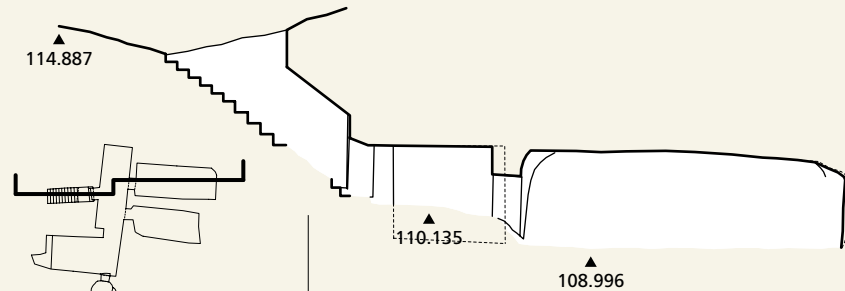
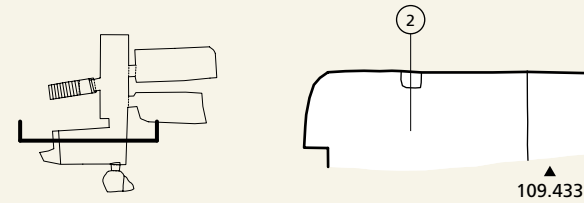
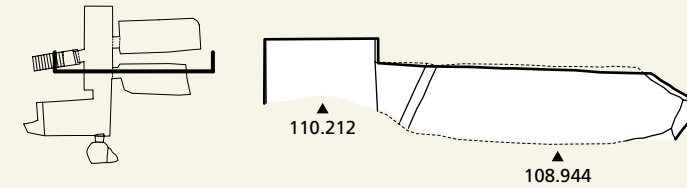

Courtesy of the Getty
Conservation Institute
and the Ministry of
Tourism and Antiquities.