

NOTES

- | | |
|---|--|
| 1 | Door jamb has slot cut at top for a lintel beam; jamb is mostly reconstructed concrete. |
| 2 | Door jamb is reconstructed concrete. There was likely a slot cut at the top for a lintel beam, but it is now filled with concrete. |
| 3 | Position and dimensions of sarcophagus approximate. |

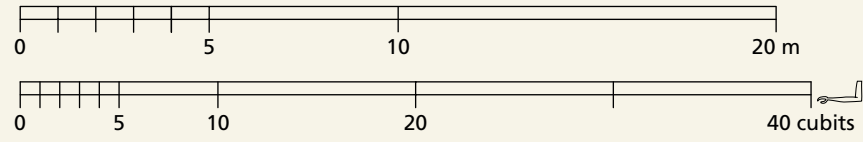

N 97,899.465
E 93,859.378
Elev 117.166

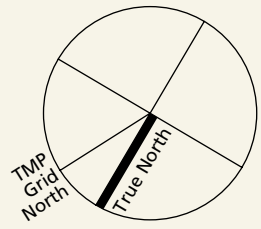
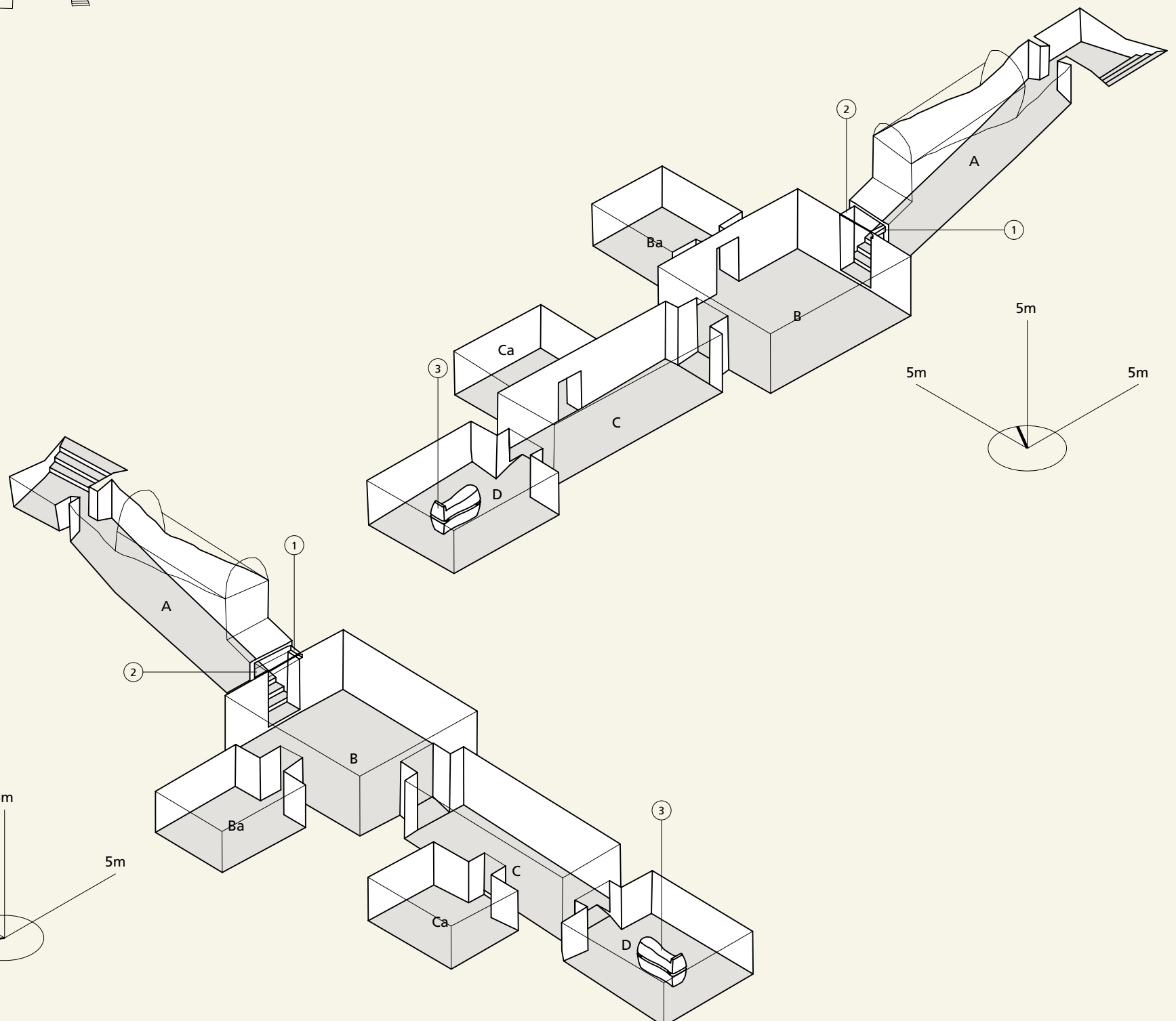
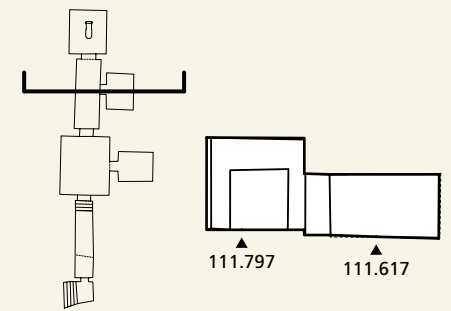
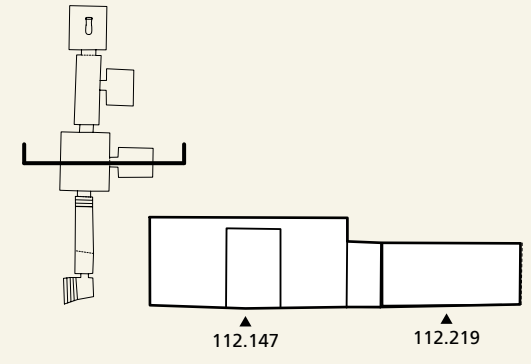
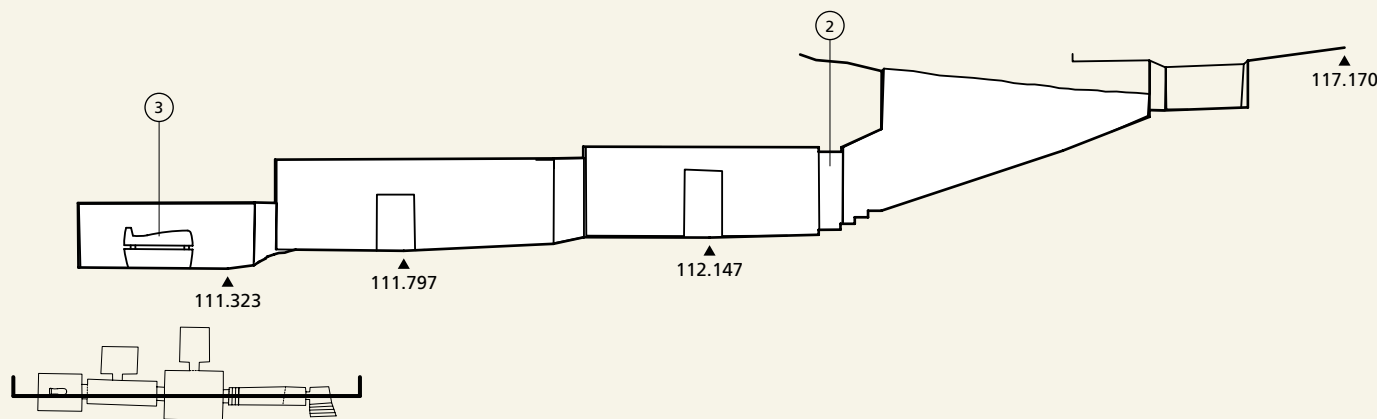
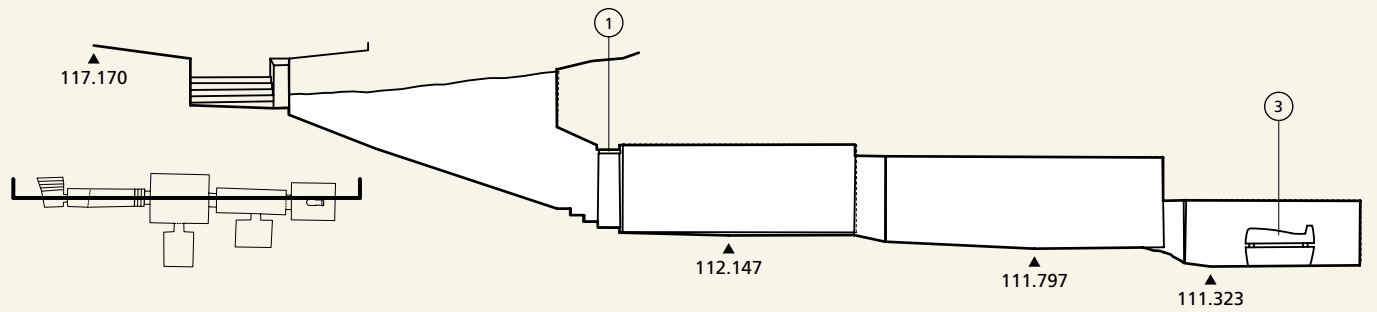
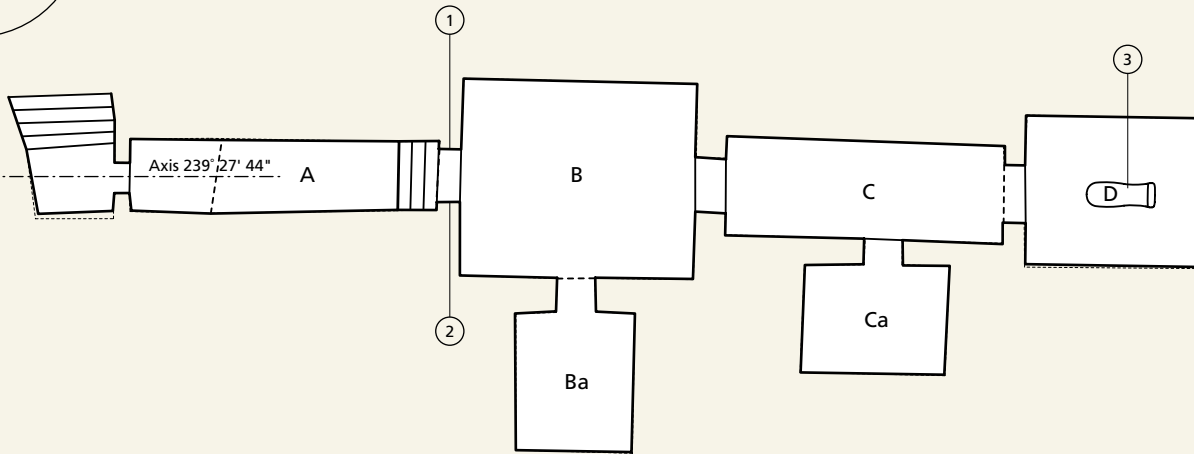

Courtesy of the Getty
Conservation Institute
and the Ministry of
Tourism and Antiquities.